



Sheet Issuance
June 29, 2020

Revisions

Hilltop Athletic Complex
for
Reading Community Schools
2236 Bolser Drive, Reading, Ohio 45215

Concept Design

Not Published.
All Rights Reserved.
This document is the product of an exclusive property of the Architect. This document and the information it contains may not be copied or used for other than the specific purpose for which it was prepared without the written consent of VSWC Architects.



VSWC Project Number: 228-12

Site Plan

Option Notes:

Field Orientation
Baseball- Best Orientation
Softball- Worst Orientation

Existing Tree Lines
No tree lines on the site disturbed

Site Grading Required
Small sloped bank required in right/ center at Baseball Field

Storm System Requirements
Catch basins or swale required in left field at the Baseball Field

Field Accessibility
Baseball- Long walk to field
Softball- Short walk to field

Safety
Parking Lot- Safe from foul balls
Spectators- Line drive foul balls between fields

Adjacent Neighborhood
Baseball- Screening required in right/ center field

Land Area Remaining for Practice
No large site area left for practice or additional fields

Future Concession/ Restroom
Area left for future building

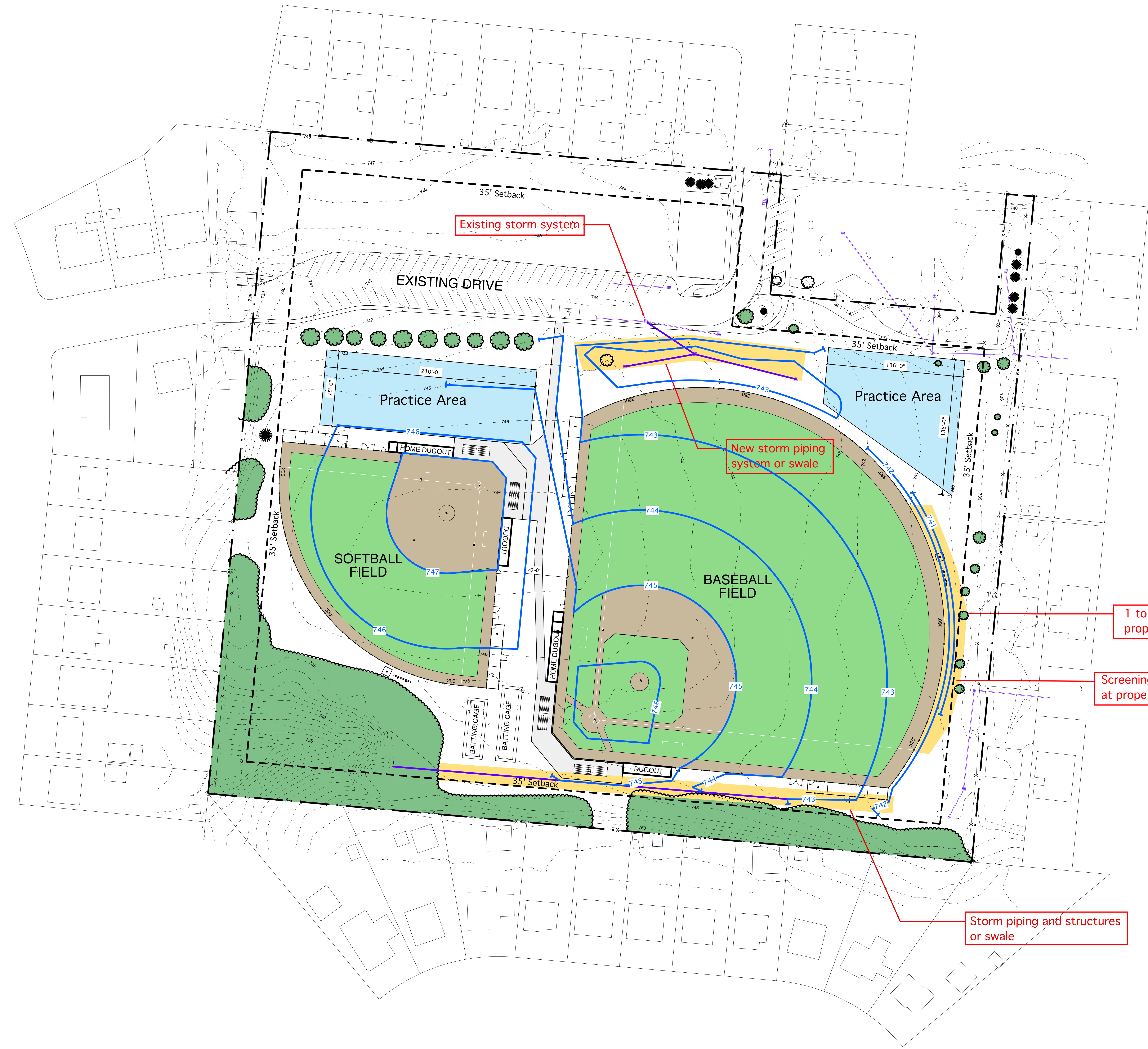

Proposed Athletic Facilities Site Plan

Scale: 1" = 40'-0"

Option 4